



Public Works

LOS ANGELES COUNTY

**Community Meeting
Streetlight Request
Petition No. 56-1017**

Announcements

1.	Please keep your personal computer or phone muted unless speaking
2.	Type your name, address, and telephone number in the chat box
3.	For those who called in, please identify yourself and provide address, and telephone number.
4.	Type your questions in the chat box. If you are calling in, we will accept your questions upon conclusion of the PowerPoint presentation.



PROPOSED STREET LIGHTING DISTRICT ANNEXATION

PETITION NO. 56-1017

ARROW HIGHWAY – LEAF AVENUE TO CITY OF AZUSA BOUNDARY

YOU ARE INVITED TO ATTEND A VIRTUAL MEETING

ZOOM ONLINE

Log on: <https://zoom.us/join> Meeting I.D.: 935 129 9122 Or Dial-In: (213) 338-8477

DATE: January 27, 2022 TIME: 6:30 PM

Dear Property Owner:

Los Angeles County Public Works is pleased to host a community meeting to address any questions or concerns from affected property owners regarding the proposed annexation of your area to the County Lighting Districts to install streetlights. Enclosed is a map showing the proposed annexation boundary, parcels to be annexed, and location of the streetlights.

To accommodate for restrictions imposed by COVID-19, the meeting will be held via the Zoom platform. Please use the website or dial-in information to attend the meeting at the designated time and date.

Petition No. 56-1017 was signed by property owners representing 66 percent of the area proposed for annexation and met the County's minimum requirement of 60 percent to initiate an annexation. The proposed annexation will result in a new annual assessment of \$5 per single-family residence to supplement the operation and maintenance costs of new streetlights.

If you have any questions, please contact Mr. Tony Trujillo with Traffic Safety and Mobility Division, Street Lighting Section, at (626) 300-4865 or trujill@pw.lacounty.gov between 7:00 a.m. and 5:00 p.m., Monday through Thursday. **Refer to Petition No. 56-1017.** Persons who are deaf or hard of hearing may make contact by first dialing the California Relay Service at 7-1-1.

Si necesita asistencia con la traducción a Español, por favor comuníquese con el representante del departamento de Obras Públicas del Condado de Los Angeles, Sr. Joaquin Cabrera al (626) 300-4760.



Individuals requiring reasonable accessibility accommodations may request written materials in alternate formats, physical accessibility accommodations, sign language interpreters or other reasonable accommodations by contacting our departmental Americans with Disabilities Act Coordinator at (626) 458-4081, from 7:30 a.m. to 5 p.m., Monday through Thursday (excluding holidays). Persons who are deaf or hard of hearing may make contact by first dialing the California Relay Service at 7-1-1. Requests should be made at least 1 week in advance to ensure availability.

PREPARED BY THE LOS ANGELES COUNTY PUBLIC WORKS

FOLLOW US ON TWITTER @LACoPublicWorks, @LACoGrModal

Why Are We Hosting a Community (Virtual) Meeting

- We are hosting this 1st virtual community meeting to provide homeowners with a request for the annexation and installation of streetlights in your neighborhood.
- A community meeting, previously scheduled in April 2020, was cancelled due to COVID-19 social distancing requirements.
- You received this virtual community meeting invitation because your property is within the proposed annexation area. All property owners whose parcels are located within the proposed annexation area were sent invitations to join the virtual community meeting.



Petition No. 56-1017 Arrow Highway

- In February 2018, Public Works prepared and mailed a streetlight petition at the request of a member of the community.
- The petition was circulated and returned to us in March 2018. The petition obtained the signatures of property owners representing 66% of the area proposed for annexation, meeting the County's 60% or more property owner signature requirement.
- The petition identified a \$0 cost for streetlight installation and a \$5 annual assessment per single-family home for streetlight operation and maintenance.
- The petition included a map identifying the proposed annexation boundaries, existing Lighting District boundaries and the benefitted properties affected.

Property Owner Signatures

COUNTY OF LOS ANGELES
DEPARTMENT OF PUBLIC WORKS
ANNEXATION TO COUNTY LIGHTING MAINTENANCE DISTRICT 1687
AND COUNTY LIGHTING DISTRICT LANDSCAPING AND LIGHTING ACT-1,
UNINCORPORATED ZONE
PETITION NO. 56-1017
ARROW HIGHWAY

The Honorable Board of Supervisors
County of Los Angeles
383 Kenneth Hahn Hall of Administration
500 West Temple Street
Los Angeles, CA 90012

Dear Supervisors:

We, the undersigned owners of real property within the area designated by the attached map, respectfully request that:

1. The area be annexed to County Lighting Maintenance District 1687 and County Lighting District Landscaping and Lighting Act-1, Unincorporated Zone.
2. Provisions be made for the installation, operation, and maintenance of streetlights and the assessment of the costs thereof.

We understand if this petition is found to contain the signatures of the property owners who represent 60 percent or more of the benefited area, a ballot will be mailed to each property owner within the proposed annexation area to indicate the property owner's support or opposition to the proposed assessment. Should the above criteria be met, the estimated amount of the first year's assessment for each benefitted property is as follows:

ESTIMATED ASSESSMENT FOR FISCAL YEAR (FY) 2018-19

Single-Family Dwelling

A. Installation Cost	\$ 0
B. Operation and Maintenance Cost for FY 2018-19	\$ 5
Total Estimated Annual Assessment	\$ 5

The above assessment will be added to the FY 2018-19 tax bills of property owners of developed properties within the benefited area. Each year, thereafter, an assessment for operation and maintenance costs of the streetlights, approved by the Board, will be added to the tax bill of property owners.

Petition No. 56-1017
Page 2

We declare that:

We are the owners of real property within that certain territory designated on the attached map and are in favor of the annexation of the area to County Lighting Maintenance District 1687, and County Lighting District Landscaping and Lighting Act-1, Unincorporated Zone, and the installation of streetlights on new or existing wood poles. Attached is a photograph copy of the type of pole to be installed.

Please sign and print your name and telephone number.

Respectfully,

SIGNATURE	PRINT NAME	ADDRESS	TELEPHONE NUMBER	APN (COUNTY USE ONLY)
		17221 E Arrow Hwy		8620-004-046
		17227 E Arrow Hwy	626 506-9709	8620-004-047
<i>[Signature]</i>	Deleph B. Buz, ABC 471	17233 E Arrow Hwy	626 309-9926	8620-004-048
		Mailing Address 8941 Duarte Rd San Gabriel, CA 91775-1556		8620-004-049
<i>[Signature]</i>	W. J. ...	17239 E Arrow Hwy	626 363-65	8620-004-050
<i>[Signature]</i>	...	17245 E Arrow Hwy	626 309-9927	8620-004-051
<i>[Signature]</i>	...	17251 E Arrow Hwy	626 208-8728	8620-004-052
<i>[Signature]</i>	...	17257 E Arrow Hwy	626 309-7624	8620-004-053
<i>[Signature]</i>	...	17263 E Arrow Hwy	310 866-9670	8620-009-001
<i>[Signature]</i>	...	17205 E Arrow Hwy		8620-009-001

Attach.

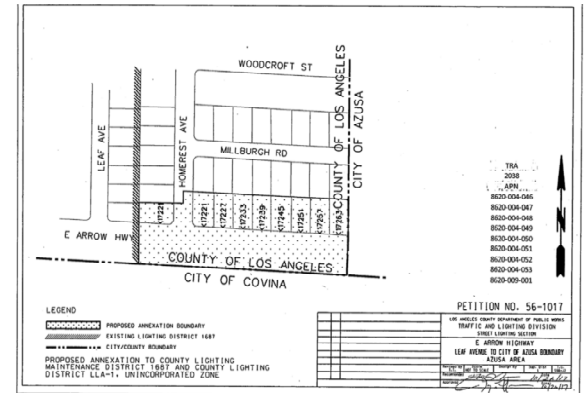

Streetlight Design Based on Existing Roadway Conditions

- **Streetlight design is based on the existing roadway conditions.**
- **Public Works conducted a field review to identify existing physical structures or impediments, such as utility poles, underground pull boxes, trees, curb and gutter, and sidewalk.**
- **The Engineer determined that four existing utility poles located along the frontage road median within the annexation area can be utilized to install streetlights on dual mast arms to illuminate the frontage road as well as Arrow Hwy.**
- **There is no cost for streetlight installation when utilizing existing utility poles.**

Annexation Map with Streetlight Design

Petition No. 56-1017 Streetlight Design

- Utilizes 4 existing utility poles located along the frontage road median.
- Proposes two streetlights on each pole with dual mast arms to illuminate Arrow Hwy and the Arrow Hwy frontage road.
- Four 82-Watt LED streetlights are proposed on Arrow Hwy and four 39-Watt LED streetlights are proposed on the Arrow Hwy frontage road, as shown on the attached map.

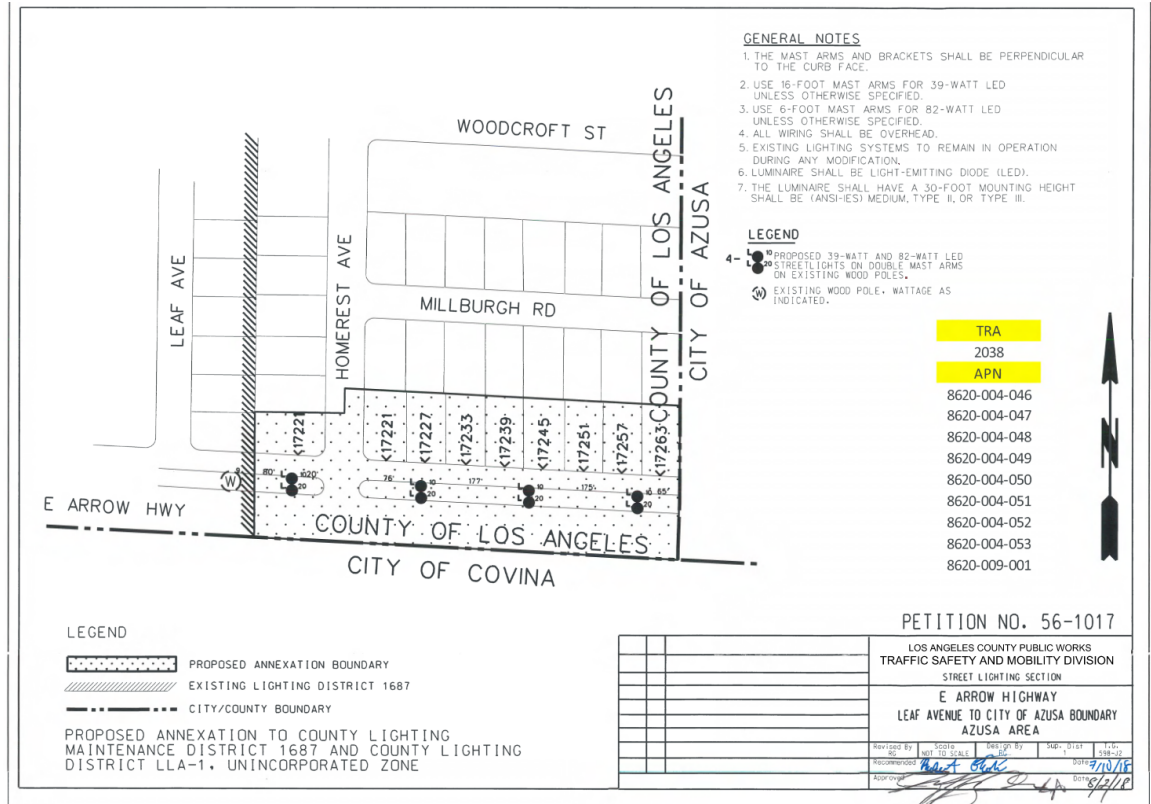

Recommend Streetlight Design Utilizing Existing Utility Poles

- Sample picture of a utility pole with streetlights on dual mast arms.

Picture of Power Pole with Dual Mast Arm



Annexation to the County Lighting Districts

NEXT STEPS

The Next Steps include:

Step 1. File Petition No. 56-1017 with the County Board of Supervisors and obtain approval to initiate annexation proceedings and prepare an Engineer's Report as required by law. *(The Engineer's Report describes the proposed street lighting improvements, costs for the improvement, annual levy of assessments, listing of properties proposed for annexation, and a map showing the annexation boundaries and streetlight design.)* Following Board of Supervisors approval, Public Works to:

- Prepare and obtain legal documents within the Department and outside Agencies.
- Schedule a 2nd community meeting to provide an update and address any issues or concerns from the affected property owners.

Step 2. File the Engineer's Report with the Board of Supervisors and request the Board to approve a Resolution of Intention to annex and levy assessments and set a date for a public hearing 45 days in advance. Following Board approval, Public Works to:

- Mail a Public Hearing notice and an Assessment Ballot to each property owner within the proposed annexation area 45 days in advance of the public hearing.
- Notice of Public Hearing will be posted within the annexation area at least 10 days prior to the hearing date.

Step 3. Hold a public hearing to hear public testimony on the proposed annexation and levying of assessments.

- At the conclusion of the public hearing, assessment ballots will be tabulated. If no majority protest, the annexation will be approved, and streetlights will be authorized for installation. If there is a majority protest, the item will be referred back to Public Works.



Contact Information

Tony Trujillo

(626) 300-4865

Email: ttrujill@pw.lacounty.gov

Public Works Hotline: (626) 458-5100